



WESTWOODLEBER
LET US GUIDE YOU HOME

Brice Gardens, Buntingford, SG9 9GR
£475,000



Brice Gardens, Buntingford, SG9 9GR

Westwood Leber are delighted to bring to the market this immaculately presented three-bedroom semi-detached family home on this sought-after newly built development in Buntingford. This property offers great living accommodation throughout, comprising a modern fitted kitchen/diner, cosy lounge with airy natural lighting and three comfortable bedrooms. Further benefits include a low-maintenance, modern rear garden, downstairs w/c, en-suite shower room off the master bedroom, three-piece family bathroom suite, separate garage and allocated parking in front, and a lean-to off the back of the garage for further storage. An internal viewing is highly recommended!



WESTWOODLEBER

Ground Floor

Approx. 47.5 sq. metres (511.2 sq. feet)

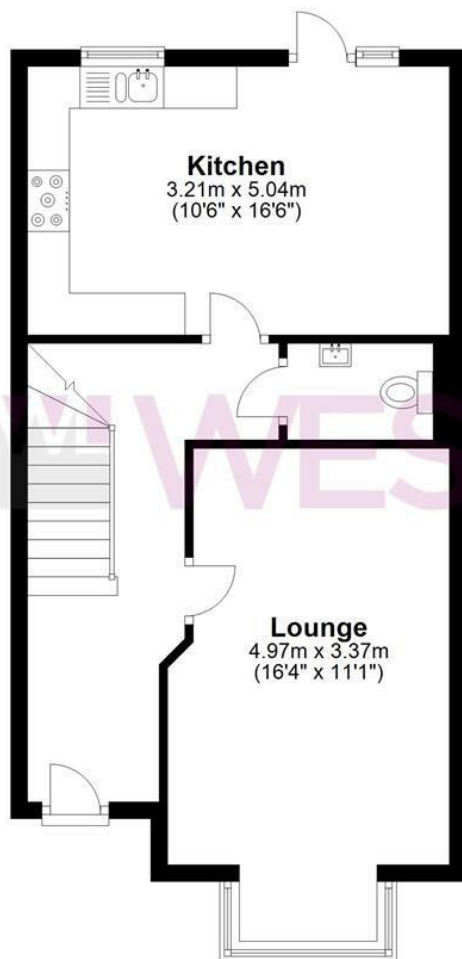

First Floor

Approx. 46.7 sq. metres (503.1 sq. feet)

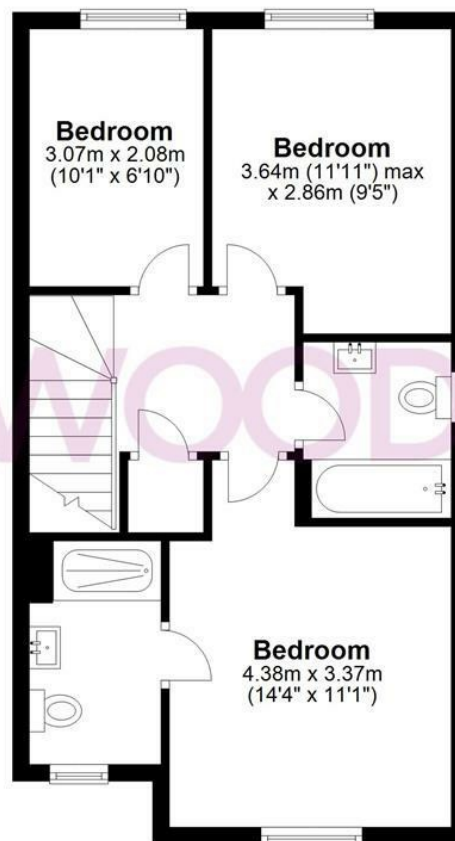

Garage

Approx. 21.6 sq. metres (232.1 sq. feet)

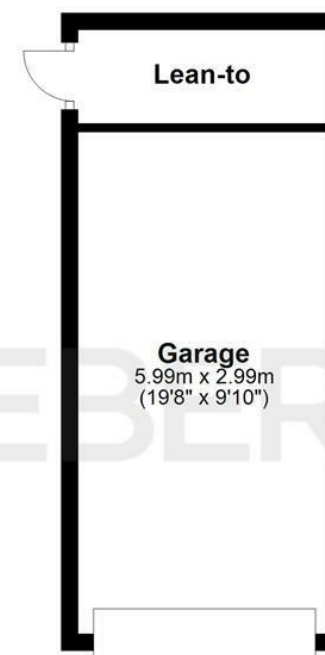

Total area: approx. 115.8 sq. metres (1246.5 sq. feet)

FOR ILLUSTRATIVE PURPOSES ONLY. NOT TO SCALE. Whilst every attempt had been made to ensure the accuracy of the floor plan shown, all measurements, positioning, fixtures, features, fittings and any other data shown are an approximate interpretation for illustrative purposes only and are not to scale. No responsibility is taken for any error, omission, miss-statement or use of data shown. Property marketing provided by Westwood Leber. Plan produced using PlanUp.









